

RB12 AERO – SINGLE PRODUCT SPECIFICATIONS



April 2017

CONTENTS

April 2017

SECTION NO.	DESCRIPTION	PAGE NO.
SECTION 1 – OVERVIEW		1.1
	PART A – GENERAL SCHEMATIC	1.1
	PART B – SHADE OPERATION	1.2
	PART C – SYSTEM OPTIONS	1.3
SECTION 2 – SYSTEM SPECIFICATIONS		2.1
	PART A – SYSTEM CAPACITY	2.1
	PART B – SPRING CAPACITY	2.2
	PART C – SYSTEM WEIGHTS (LBS)	2.5
SECTION 3 – TEST SUMMARY		3.1
SECTION 4 – MATERIAL SPECIFICATIONS		4.1
SECTION 5 – WARRANTY		5.1
SECTION 6 – SPECIFICATION IMAGES		6.2
	PART A – DEDUCTIONS	6.2
	PART B – ROLL DETAILS	6.2

DISCLAIMER

INTRODUCTION

This product specifications manual has been produced by Rollease Acmeda to supply the necessary information for safe and correct assembly and installation of this system.

DISCLAIMER

Rollease Acmeda has used reasonable care in preparing the information included in this document, but makes no representations or warranties as to the completeness or accuracy of the information. Information is supplied upon the condition that the persons receiving the information will make their own determination as to its suitability for their purposes prior to use. Rollease Acmeda assumes no liability whatsoever for any damages incurred by you resulting from errors in or omissions from the information included herein. Rollease Acmeda reserves the right to make changes without further notice to any products to improve reliability, function or design.

COPYRIGHT

COPYRIGHT © ROLLEASE ACMEDA 2017

All rights reserved. No part of this document may be reproduced or utilized in any means, by any means, electronic or mechanical including photocopying, recordings, or by any information storage or retrieval system, without the express permission from Rollease Acmeda.

SECTION 1 – OVERVIEW

PART A – GENERAL SCHEMATIC

Our innovative AERO roller system, offers a premium aesthetically pleasing and technologically advanced solution. Controlling the shades with either chain or independent spring mechanism, raising and lowering shades to your preferred top and bottom locations, with one simple touch.

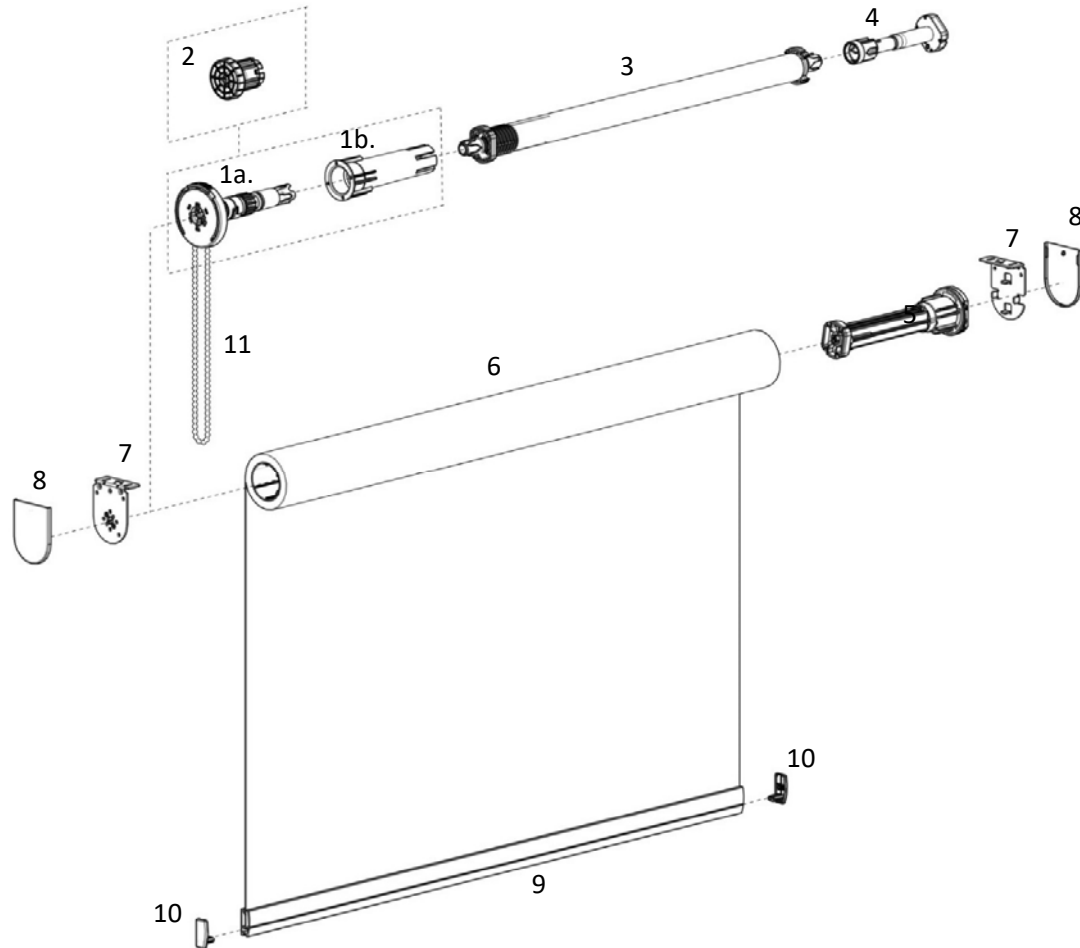

Note: This configuration is primarily shown throughout manuals; Left handed, Back Roll, Chain Control

SYSTEM INDEX

- 1a. Aero Single Chain Winder
- 1b. Aero Connector - Chain Winder/Booster
2. Aero Single Chainfree Control
3. Booster Univ.
4. Aero Decelerator
5. Aero Limiter Idle End
6. S45 Aluminum Tube
7. Aero Single LX Bracket – Chain Winder/Limiter
8. Bracket Cover LX / VX
9. D30 SILENT Medium Alum. Bottom Rail
10. D30 SILENT Medium Bottom Rail End Caps
11. Chains & Accessories

PART B – SHADE OPERATION

DOWN:
PULL Bottom Rail

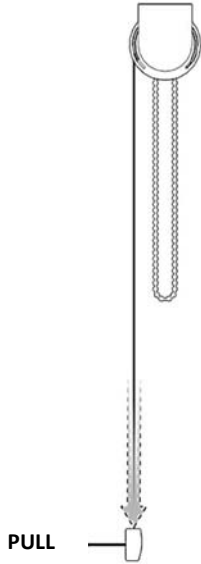

UP:
TUG Bottom Rail
(Shade will automatically rise)

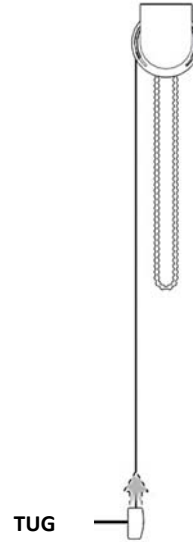

Or

DOWN:
PULL Chain

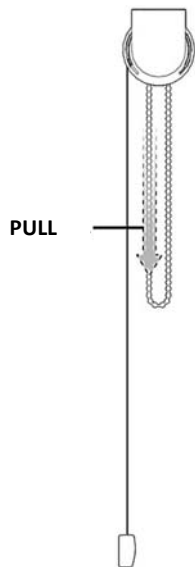

Or

UP:
TUG & LIFT Chain
(Shade will automatically rise)

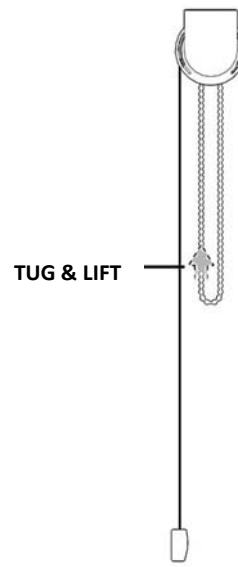

PART C – SYSTEM OPTIONS

CONTROL OPTIONS

CHAIN



CHAINFREE

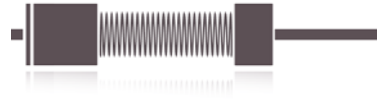

ADD ONS

ROUND CASSETTE



SQUARE CASSETTE

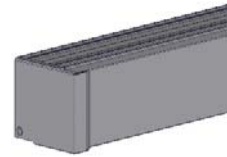

MOUNTING RAIL



EASY LINK

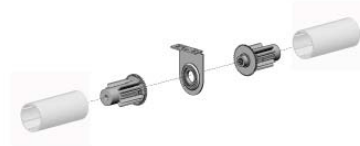

COLOR RANGE



pure white
069







silver grey
338

SECTION 2 – SYSTEM SPECIFICATIONS

PART A – SYSTEM CAPACITY

D30 Medium Weight Bar (No Ballast) | 17.7 oz/yd²

Drop (ft)	Width (ft)																		
	2.0			4.0			6.0			8.0			10.0			12.0			14.0
2.0																			
4.0																			
6.0																			
8.0																			
10.0																			
12.0																			
14.0																			
16.0																			
18.0																			

LEGEND	DESCRIPTION
	S45 All tubes
	S45 STD + HD
	S45 HD
	S45 Easy-Link (Single Shade Only)
	Cannot be achieved - outside product specifications

PART B – SPRING CAPACITY

S45 LT TUBE – D30 Medium Weight Bar (No Ballast) | 17.7 oz/yd²

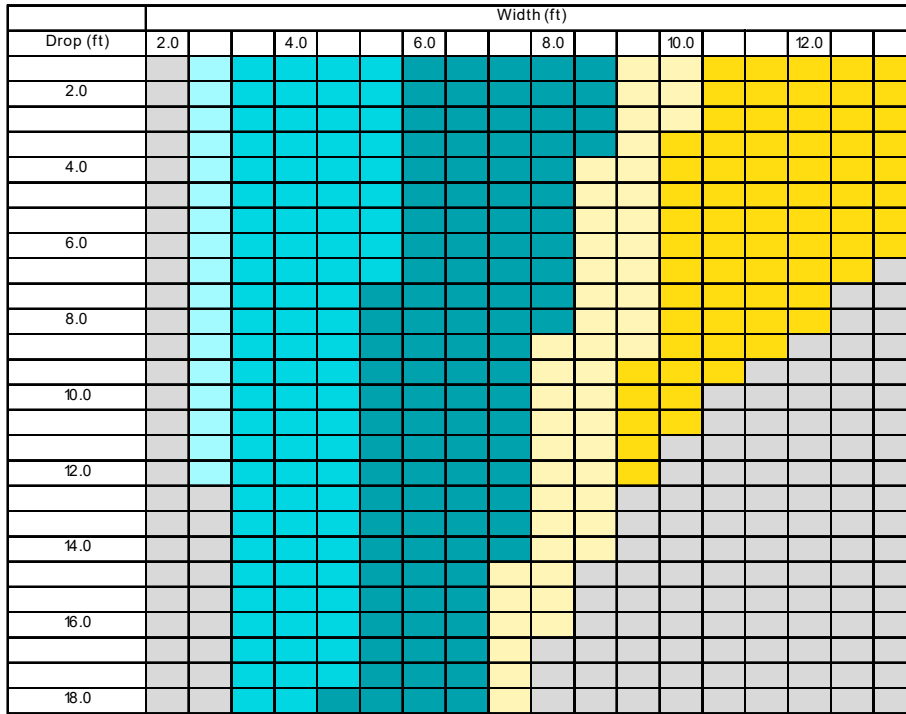

LEGEND	DESCRIPTION	COLOR
	RB12 S45 Universal Booster - Short	
	RB12 S45 Universal Booster - Light	
	RB12 S45 Universal Booster - Standard	
	RB12 S45 Universal Booster - Standard with Easy Link	
	RB12 S45 Universal Booster - Heavy Duty with Easy Link	
	Cannot be achieved - outside product specifications	-

NOTE: The above charts are indicative only. Due to variances in fabric weights, weight bar weights, addition of ballast and friction the optimum booster will vary shade to shade.

S45 STD TUBE – D30 Medium Weight Bar (No Ballast) | 17.7 oz/yd²

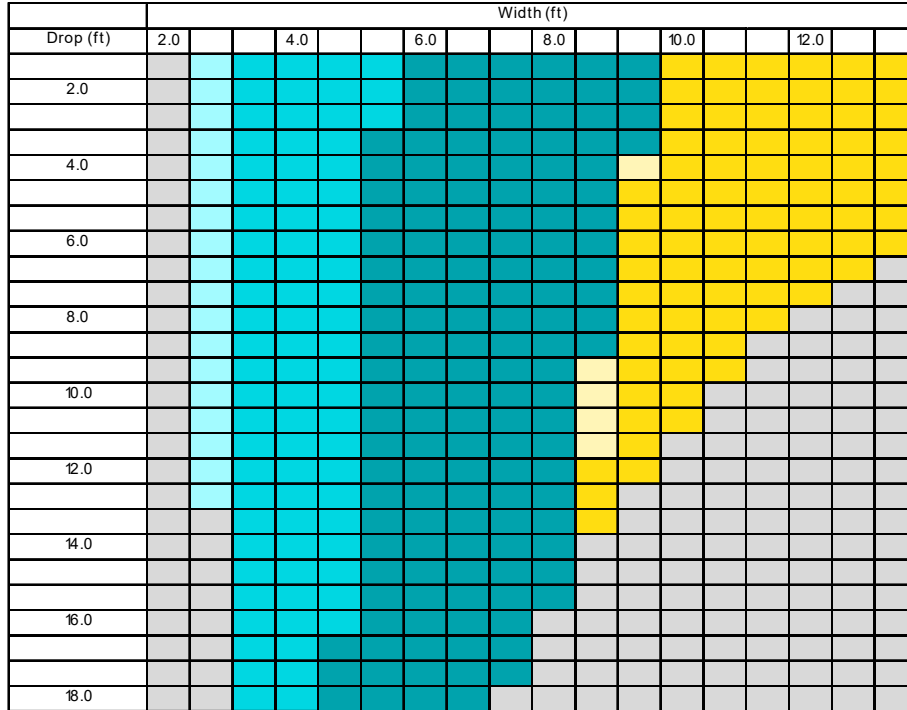

LEGEND	DESCRIPTION	COLOR
Light Blue	RB12 S45 Universal Booster - Short	
Light Blue	RB12 S45 Universal Booster - Light	
Light Blue	RB12 S45 Universal Booster - Standard	
Light Blue	RB12 S45 Universal Booster - Standard with Easy Link	
Light Blue	RB12 S45 Universal Booster - Heavy Duty with Easy Link	
Light Blue	Cannot be achieved - outside product specifications	-

NOTE: The above charts are indicative only. Due to variances in fabric weights, weight bar weights, addition of ballast and friction the optimum booster will vary shade to shade.

S45 HD TUBE – D30 Medium Weight Bar (No Ballast) | 17.7 oz/yd²

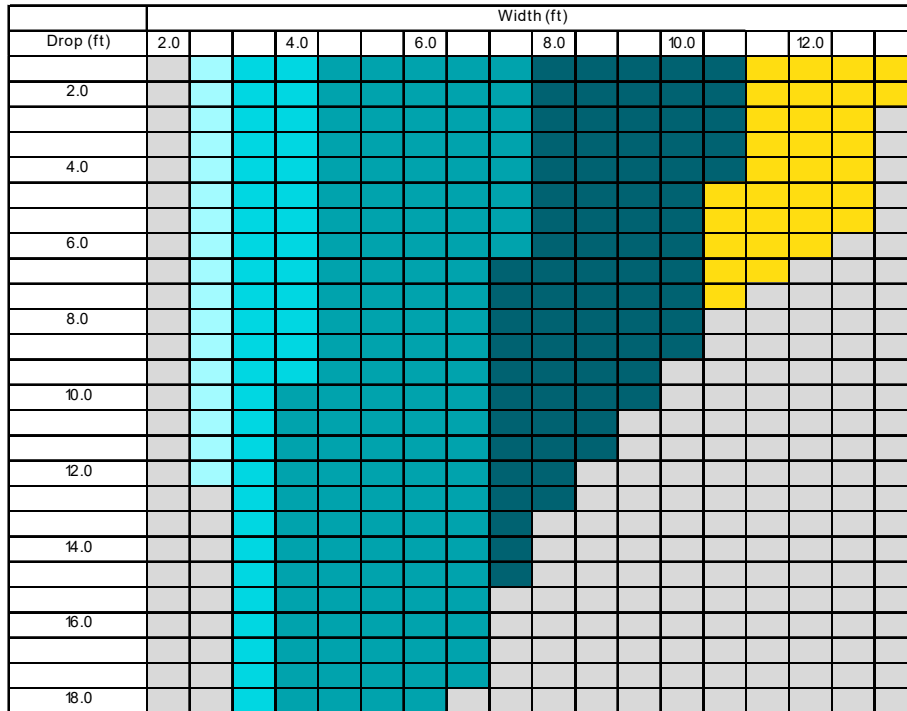

LEGEND	DESCRIPTION	COLOR
	RB12 S45 Universal Booster - Short	
	RB12 S45 Universal Booster - Light	
	RB12 S45 Universal Booster - Standard	
	RB12 S45 Universal Booster - Heavy Duty with Easy Link	
	Cannot be achieved - outside product specifications	-

NOTE: The above charts are indicative only. Due to variances in fabric weights, weight bar weights, addition of ballast and friction the optimum booster will vary shade to shade.

PART C – SYSTEM WEIGHTS (LBS)

SYSTEM – Open Shade, S45 STD Tube, D30 Weight Bar (No Ballast)

Drop (ft)	Width (ft)																	
	2	2.6	3.3	3.9	4.6	5.2	5.9	6.6	7.2	7.9	8.5	9.2	9.8	10	11	12	12	13
1.6		4.3	4.9	5.4	5.9	6.4	6.9	7.4	8.0	8.5	9.0	9.5	10.0	10.5	11.1	11.6	12.1	12.6
2.0		4.4	4.9	5.5	6.0	6.6	7.1	7.6	8.2	8.7	9.2	9.8	10.3	10.8	11.4	11.9	12.4	13.0
2.3		4.5	5.0	5.6	6.1	6.7	7.3	7.8	8.4	8.9	9.5	10.0	10.6	11.1	11.7	12.2	12.8	
2.6		4.6	5.1	5.7	6.3	6.8	7.4	8.0	8.6	9.1	9.7	10.3	10.9	11.4	12.0	12.6	13.1	
3.0		4.6	5.2	5.8	6.4	7.0	7.6	8.2	8.8	9.4	9.9	10.5	11.1	11.7	12.3	12.9	13.5	
3.3		4.7	5.3	5.9	6.5	7.1	7.7	8.4	9.0	9.6	10.2	10.8	11.4	12.0	12.6	13.2	13.8	
3.6		4.8	5.4	6.0	6.7	7.3	7.9	8.5	9.2	9.8	10.4	11.1	11.7	12.3	12.9	13.6	14.2	
3.9		4.8	5.5	6.1	6.8	7.4	8.1	8.7	9.4	10.0	10.7	11.3	12.0	12.6	13.2	13.9		
4.3		4.9	5.6	6.2	6.9	7.6	8.2	8.9	9.6	10.2	10.9	11.6	12.2	12.9	13.6			
4.6		5.0	5.7	6.3	7.0	7.7	8.4	9.1	9.8	10.5	11.1	11.8	12.5	13.2				
4.9		5.1	5.8	6.5	7.2	7.9	8.6	9.3	10.0	10.7	11.4	12.1	12.8					
5.2		5.1	5.8	6.6	7.3	8.0	8.7	9.4	10.2	10.9	11.6	12.3	13.1					
5.6		5.2	5.9	6.7	7.4	8.2	8.9	9.6	10.4	11.1	11.8	12.6						
5.9		5.3	6.0	6.8	7.5	8.3	9.1	9.8	10.6	11.3	12.1	12.8						
6.2		5.3	6.1	6.9	7.7	8.4	9.2	10.0	10.8	11.5	12.3							
6.6		5.4	6.2	7.0	7.8	8.6	9.4	10.2	11.0	11.8	12.6							
6.9		5.5	6.3	7.1	7.9	8.7	9.5	10.4	11.2	12.0								
7.2		5.5	6.4	7.2	8.0	8.9	9.7	10.5	11.4	12.2								
7.5			6.5	7.3	8.2	9.0	9.9	10.7	11.6	12.4								
7.9			6.6	7.4	8.3	9.2	10.0	10.9	11.8	12.6								
8.2			6.6	7.5	8.4	9.3	10.2	11.1	12.0	12.9								
8.5			6.7	7.6	8.5	9.5	10.4	11.3	12.2	13.1								
8.9			6.8	7.8	8.7	9.6	10.5	11.5	12.4									
9.2			6.9	7.9	8.8	9.7	10.7	11.6	12.6									
9.5			7.0	8.0	8.9	9.9	10.9	11.8	12.8									
9.8			7.1	8.1	9.1	10.0	11.0	12.0										

Cannot be achieved - outside product specifications

SECTION 3 – TEST SUMMARY

TEST – CYCLE

TEST DESCRIPTION:	AERO CHAIN CONTROL AND GUIDE	TEST REPORT NUMBER:	TR-2015013
CONTROL:	Chain	Chain length:	2.4 m (7.87ft)
CYCLES PASSED:	10,000	TORQUE:	1.5 Nm (1.12 ft-lbs)

TEST DESCRIPTION:	AERO BOOSTER UNIV.	TEST REPORT NUMBER:	TR-2015028
CONTROL:	Spring	TORQUE:	SHORT 0.46 Nm (0.34 ft-lbs) LIGHT 0.60 Nm (0.44 ft-lbs) STD 1.09 Nm (0.80 ft-lbs) HD 1.77 Nm (1.31 ft-lbs)
CYCLES PASSED:	6,000		

TEST DESCRIPTION:	AERO PRETENSION	TEST REPORT NUMBER:	TR-2015011
CONTROL:	Spring	Pretension adjustment:	Every 1,000 cycles
CYCLES PASSED:	10,000	TORQUE:	2.4 Nm (1.77 ft-lbs)

TEST DESCRIPTION:	AERO POSITION STOP	TEST REPORT NUMBER:	TR-2015016
CONTROL:	NA	Stop positions:	6
CYCLES PASSED:	10,000	TORQUE:	1.5 Nm (1.11 ft-lbs)

TEST DESCRIPTION:	AERO LIMITER IDLER END	TEST REPORT NUMBER:	TR-2015014
CONTROL:	NA	Limit:	Top and bottom
CYCLES PASSED:	Bottom 6,000 Top 6,000	TORQUE:	3.5Nm (2.58 ft-lbs)

TEST DESCRIPTION:	FULL SYSTEM	TEST REPORT NUMBER:	TR-2015017
CONTROL:	Chain (HD SPRING)	Shade Size:	2.4 m x 2.8m
CYCLES PASSED:	12,000	SHADE WEIGHT (Fabric + W/B):	2.94 kg (0.46Nm)

TEST – PRODUCT EVALUATION (FABRICATION, INSTALLATION, OPERATIONAL)

TEST DESCRIPTION:	SINGLE SHADE	PRODUCT LOCATION:	R&T
SHADE WIDTH:	1200mm (3.9 ft)	SHADE DROP:	2100mm (6.9 ft)
CONTROL:	Chain (STD Spring)	FABRIC:	FOCUS, 400 gsm (16.87 oz.yd ²), 0.4mm thickness (0.018")
INSTALLATION:	Wall mount, Mounting Rail		

TEST DESCRIPTION:	SINGLE SHADE	PRODUCT LOCATION:	R&T
SHADE WIDTH:	1200mm (3.9 ft)	SHADE DROP:	2100mm (6.9 ft)
CONTROL:	Spring (STD)	FABRIC:	FOCUS, 400 gsm (16.87 oz.yd ²), 0.4mm thickness (0.018")
BRACKET INSTALLATION:	Wall mount, Mounting Rail		

TEST DESCRIPTION:	SINGLE SHADE	PRODUCT LOCATION:	R&T
SHADE WIDTH:	1500mm (4.9 ft)	SHADE DROP:	1800mm (5.9ft)
CONTROL:	Spring (STD)	FABRIC:	BALMORAL, 390gsm (16.45 oz.yd ²), 0.6mm thickness (0.02")
BRACKET INSTALLATION:	Ceiling mount, Cassette		

TEST DESCRIPTION:	SINGLE SHADE	PRODUCT LOCATION:	IDC
SHADE WIDTH:	2400mm (7.9 ft)	SHADE DROP:	2800mm (9.2 ft)
CONTROL:	Chain (HD Booster) (49mm [1.93"] Tube)	FABRIC:	363 gsm(15.31 oz.yd ²), 0.46mm (0.02") thickness
BRACKET INSTALLATION:	Wall mount, Open		

SECTION 4 – MATERIAL SPECIFICATIONS

PART NO.	PRODUCT	MATERIAL	FINISHES
RB12-3100-xxx140	AERO Single Chain Winder LH S45	Nylon - Glass Filled, POM, Mild Steel, Spring Steel,	-
RB12-3100-xxx240	AERO Single Chain Winder RH S45		
RB12-2100-xxx040	AERO Single LX Bracket – Chain / Limiter 40p S45	Nylon Glass Filled, Mild Steel	PC
RB12-2200-xxx040	AERO Single LX Bracket – Chainfree/ Limiter 40p 45	Mild Steel	PC
RB12-2300-xxx040	AERO Single LX Bracket – Chain / RB09 Idler 40p S45	PC, Nylon Glass Filled, Mild Steel	PC
RB12-4510-xxx045	AERO Connector - Chain Winder/Booster S45	ABS/PC	-
RB12-3200-xxx045	Single Chainfree Control S45	POM, ABS/PC	
RB12-6001-xxx145	AERO Limiter Idle End LH S45	Nylon - Glass Filled, POM, Santoprene, ABS/PC, Mild Steel, Spring Steel, TPU	-
RB12-6002-xxx245	AERO Limiter Idle End RH S45		
RB12-7101-xxx145	Booster Decelerator – LH S45	Nylon, POM, TPU	-
RB12-7102-xxx245	Booster Decelerator – RH S45		
RB12-4500-xxx045	Booster Univ. SHORT S45	ABS/PC, POM, Nylon, Spring Steel, PVC, Aluminum	-
RB12-4501-xxx045	Booster Univ. LGT S45		
RB12-4502-xxx045	Booster Univ. STD S45		
RB12-4503-xxx045	Booster Univ. HD S45		
RB91-1232-xxxLLL	D30 SILENT Medium Bottom Rail	Aluminum	Mill / Anod (15µm) / PC
RB91-2131-xxx002	D30 Medium Bottom Rail End Caps	POM	-
RB92-1501-001100	15mm Flat Spline	ASA	-
RB92-1502-001075	15mm Flat Spline-D/S TAPE		
RB92-1502-001075	15mm Flat Spline-D/S TAPE B/SIDES		
VB05-0301-xxxLLL	Oval Steel Tiltrod	Mild Steel	-
RB93-0443-xxxLLL	S45 LIGHT T-SPLINE Al. Tube	Aluminum	Mill / Anod (10µm)
RB93-0444-xxxLLL	S45 STD T-SPLINE Al. Tube	Aluminum	Mill / Anod (10µm)
RB93-0449-xxxLLL	S45 HD T-Spline Al. Tube	Aluminum	Mill / Anod (10µm)
RB92-0404-311215	T-Spline Slide-on	PVC	-
RB91-1336-xxx000	Chainhold Cover	LDPE, POM	-
RB91-1337-xxx000	Chainhold Base Assembly		
RB91-1338-001110	Chainhold Mounting Kit Clear		

SECTION 5 – WARRANTY

Rollease Acmeda provide a five (5) year hardware warranty against defects to the original purchaser (the fabricator/manufacturer).

The hardware warranty is not to be transferred to the end consumer.

The hardware warranty is limited to the repair or resupply of defective hardware components to the fabricator/manufacturer only.

The hardware warranty is applicable to normal use.

The hardware warranty will not apply where the defect arises due to incorrect assembly and installation.

Retailers are obliged to supply consumers with their own warranty, if required, at the point of purchase.

SECTION 6 – SPECIFICATION IMAGES

Please contact Rollease Acmeda: marketing@rolleasacmeda.com to request electronic copies of the file listed below.

PART A – DEDUCTIONS

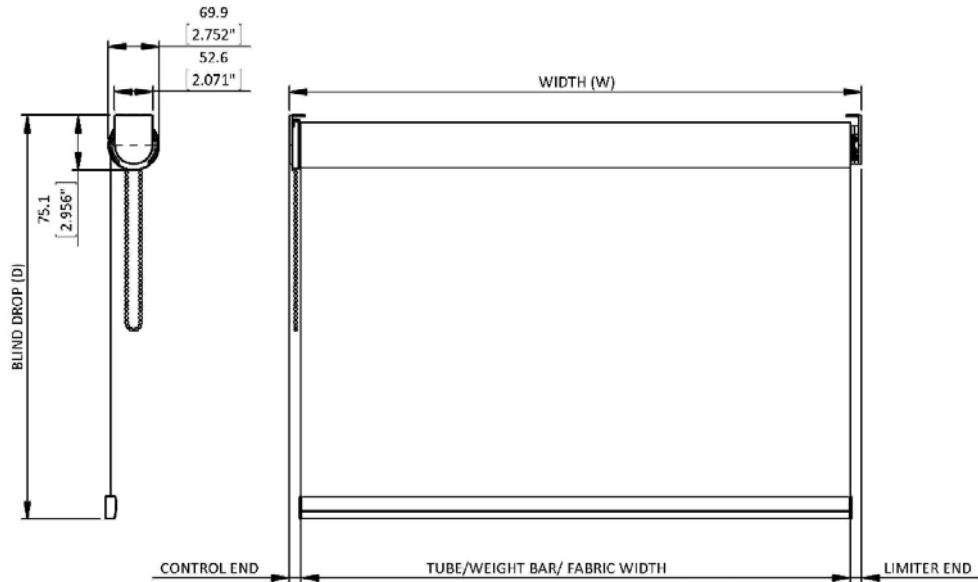

CONTROL TYPE	CONTROL END		LIMITER END	
	With Covers	WithOUT Covers	With Covers	WithOUT Covers
Chain Control	18mm (0.71")	16mm (0.63")	17mm (0.67")	15mm (0.59")
Spring Control	15mm (0.59")	14mm (0.55")	17mm (0.67")	15mm (0.59")

Filename: RB12 OT_PM_SS_Deductions2

PART B – ROLL DETAILS

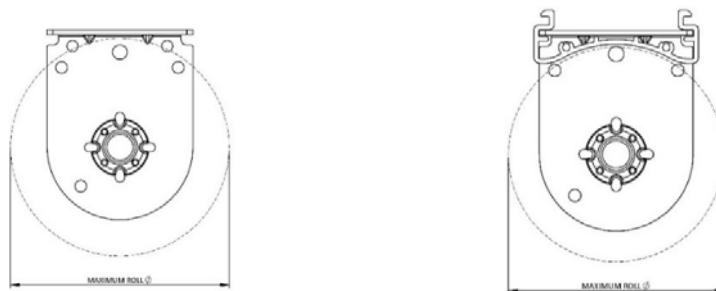

MAXIMUM ROLL SIZE CHART		
40p BRACKET		
withOUT Mounting Rail	78mm	3.071"
with Mounting Rail	72mm	2.835"

Filename: RB12_PM_Max Roll No Rail

Filename: RB12_PM_Max Roll